

# ASSEMBLY DIAGRAMS FOR PLASTIC FRL SERVICE UNITS C2/C3

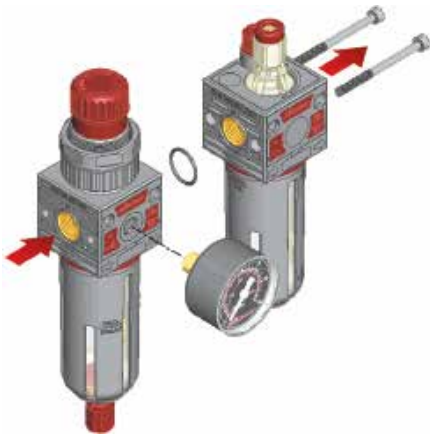

screw connection of standard FRL service unit with screws, nuts and o-ring C400500001

## Series 042

compressed air lubricator  
soft start valve  
electric switch-on valve  
filter regulator  
"T" mounting bracket C420500001

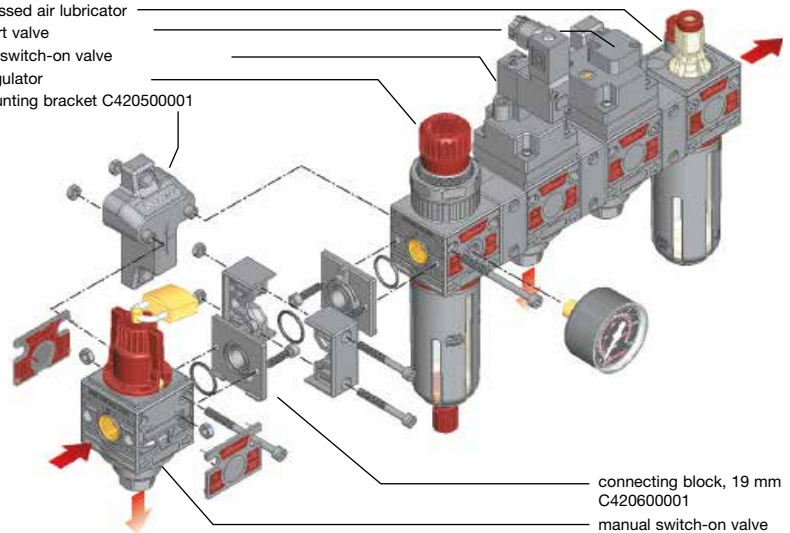

connecting block, 19 mm C420600001  
manual switch-on valve

compressed air lubricator  
soft start valve  
electrical switch-on valve  
branch plate C750600002  
mounting bracket BW42-01

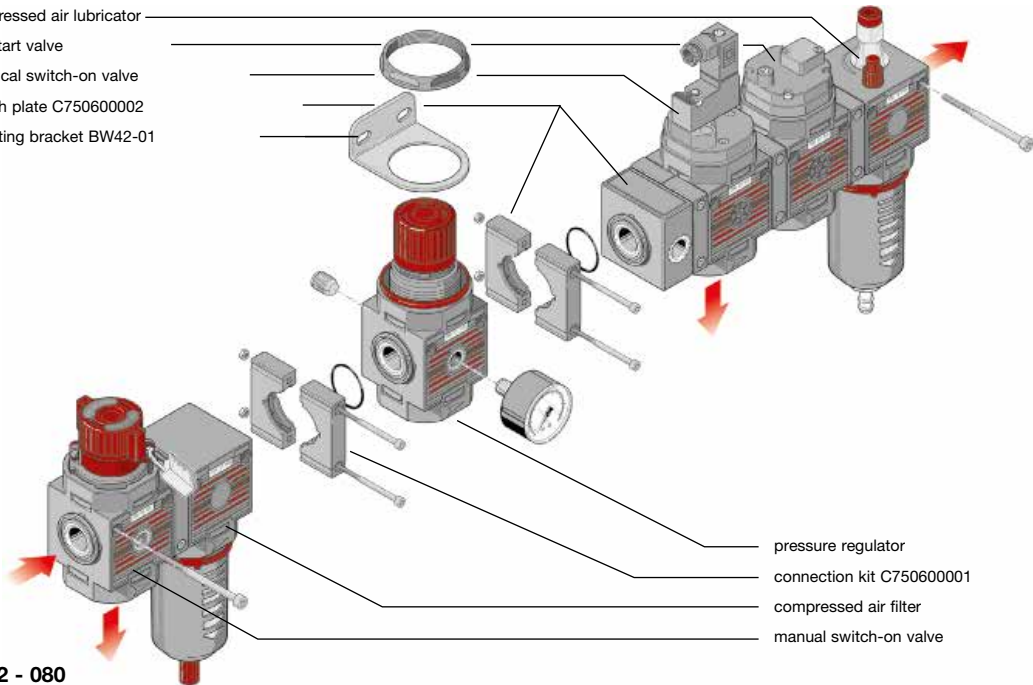

pressure regulator  
connection kit C750600001  
compressed air filter  
manual switch-on valve

## Series 075

similar to  
Series 050 - 052 - 080

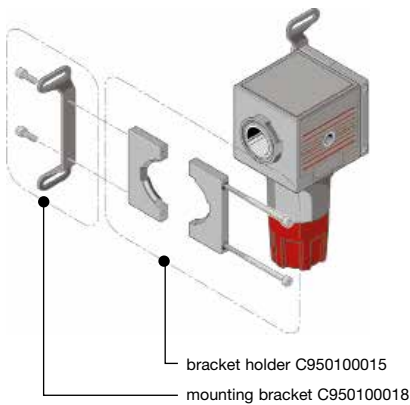

## Series 095

mounting bracket C950100018

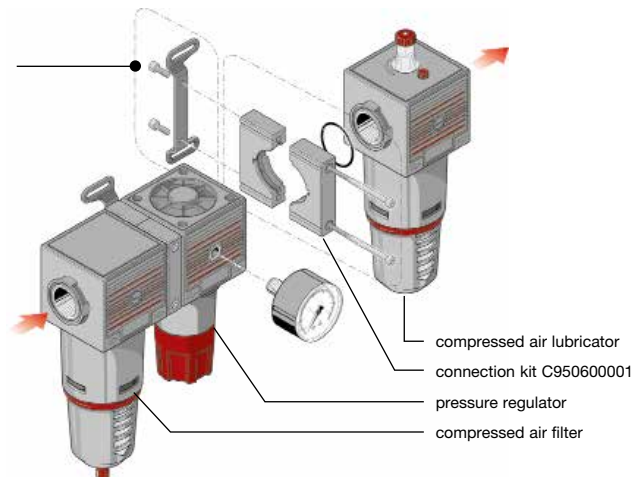

compressed air lubricator  
connection kit C950600001  
pressure regulator  
compressed air filter

|                            |   |                    |                            |
|----------------------------|---|--------------------|----------------------------|
| <b>Description</b>         | Made up of modular components which can be combined to form compact units. Switch-on and soft start valves available as additional modules. |                    |                            |
| <b>Media</b>               | compressed air or non-corrosive gases   |                    |                            |
| <b>Supply pressure</b>     | max. 12.5 bar, max. 7 bar at lubricator with oil level indicator, max. 16 bar for Series 042  |                    |                            |
| <b>Gauge port</b>          | G $\frac{1}{8}$ or G $\frac{1}{4}$ at series 095, on both sides of the body, one screw plug supplied  |                    |                            |
| <b>Filter element</b>      | 20 $\mu$ m, optionally 5 $\mu$ m, made of sintered polyethylene   |                    |                            |
| <b>Bowl</b>                | plastic version with bayonet catch, series 042 with connection thread   |                    |                            |
| <b>Drain</b>               | manual drain with semiautomatic drain, optionally automatic drain   |                    |                            |
| <b>Oil refilling</b>       | optionally with semiautomatic oil refilling without need to interrupt operation   |                    |                            |
| <b>Oil level indicator</b> | If the oil level falls below the limit value, a float will close a signal contact.  |                    |                            |
| <b>Temperature range</b>   | 0 °C to 50 °C / 32 °F to 122 °F   | <b>Contact:</b> NO | <b>Voltage:</b> max. 115 V |
| <b>Material</b>            | Body: nylon, POM at series 042  | Inner valve: brass | Thread insert: brass       |
|                            | Bowl: polyamide   |                    |                            |
|                            | Elastomer: NBR/Buna-N   |                    |                            |

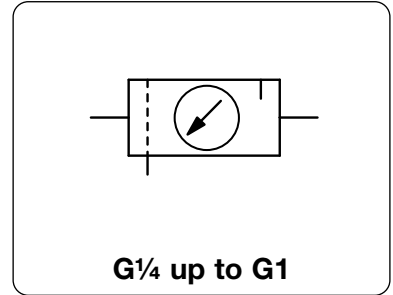

| Dimensions |    |    |    | Combination | Bowl           | Flow                | Connection | Order  |    |
|------------|----|----|----|-------------|----------------|---------------------|------------|--------|----|
| A          | B  | C  | K  | consist     | design         | rate                | thread     | number | B* |
| mm         | mm | mm | mm | of          | made of / with | m <sup>3</sup> /h*1 | l/min*1    | G      |    |

| FRL unit, 2-part |     |     |     |        | P <sub>1</sub> : max. 12.5 / 16 bar, P <sub>2</sub> : 0...8 bar, 20 $\mu$ m, semiautomatic drain, with pressure gauge |     |      | C2              |           |
|------------------|-----|-----|-----|--------|---|-----|------|-----------------|-----------|
| 84               | 208 | 126 | -   | B+L042 | plastic/  | 59  | 980  | G $\frac{1}{4}$ | C242-02HC |
| 115              | 239 | 148 | 126 | B+L050 | bowl guard  | 84  | 1400 | G $\frac{3}{8}$ | C250-03HC |
| 115              | 239 | 148 | 126 | B+L052 |   | 90  | 1500 | G $\frac{1}{2}$ | C252-04HC |
| 139              | 276 | 173 | 151 | B+L075 |   | 132 | 2200 | G $\frac{1}{2}$ | C275-04HC |
| 212              | 276 | 173 | -   | B+L080 |   | 138 | 2300 | G $\frac{3}{4}$ | C280-06HC |
| 210              | 415 | 237 | 230 | B+L095 |   | 480 | 8000 | G1              | C295-08HC |



C242

| FRL unit, 3-part |     |     |     |          | P <sub>1</sub> : max. 12.5 / 16 bar, P <sub>2</sub> : 0...8 bar, 20 $\mu$ m, semiautomatic drain, with pressure gauge |     |      | C3              |           |
|------------------|-----|-----|-----|----------|---|-----|------|-----------------|-----------|
| 126              | 208 | 126 | -   | F+R+L042 | plastic/  | 59  | 980  | G $\frac{1}{4}$ | C342-02HC |
| 178              | 239 | 148 | 189 | F+R+L050 | bowl guard  | 84  | 1100 | G $\frac{3}{8}$ | C350-03HC |
| 178              | 239 | 148 | 189 | F+R+L052 |   | 90  | 1500 | G $\frac{1}{2}$ | C352-04HC |
| 215              | 276 | 173 | 227 | F+R+L075 |   | 132 | 2200 | G $\frac{1}{2}$ | C375-04HC |
| 288              | 276 | 173 | -   | F+R+L080 |   | 138 | 2300 | G $\frac{3}{4}$ | C380-06HC |
| 325              | 411 | 237 | 345 | F+R+L095 |   | 480 | 8000 | G1              | C395-08HC |



C375

**Special options,** add the appropriate letter

|                             |   |                  |
|-----------------------------|---|------------------|
| 5 $\mu$ m filter element    |   | C...-0.G.        |
| 0...12 bar regulating range |   | C...-0...D       |
| automatic drain             | C400200130                              | C...-0...R       |
| semiautomatic oil refilling | P <sub>min.</sub> 3 bar                 | for C.42 to C.80 |
| oil level indicator         | P <sub>max.</sub> 7 bar max. 115 V / NO | for C.50 to C.95 |
|                             |   | C...-0...X65     |
|                             |   | C...-0...X66     |

**Accessories,** enclosed

|                  |   |                  |         |
|------------------|---|------------------|---------|
| mounting bracket | made of steel, mounting nut at the device | for C.42         | BW30-01 |
|                  |   | for C.50 to C.80 | BW42-01 |
| set of brackets  | made of steel, mounting nut at the device | for C.95         | BW00-02 |

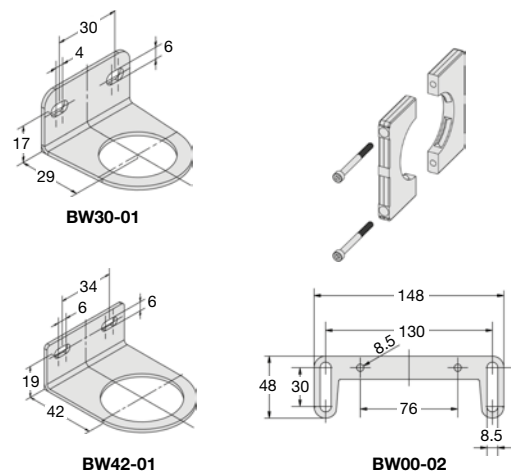
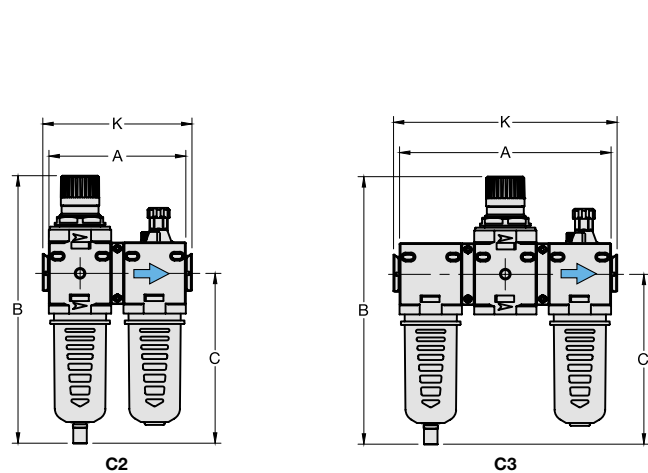

\*1 at 10 bar supply pressure, 6 bar outlet pressure and 1 bar pressure drop  
 \*2 04 = 0...4 bar, 10 = 0...10 bar, 16 = 0...16 bar

Further details: see chapter for single devices [www.aircom.net](http://www.aircom.net)

\* Product group Order example: C242-02HC